

**THE CITY OF NAPOLEON**  
**BUILDING & ZONING DEPARTMENT**

255 W. RIVERVIEW

(419)592-4010

**Plumbing Permit**

Page 1 of 1

Permit Number: PL2005-53

Printed: 9/14/2005

**Property Address: 940 Graceway Dr E.**

**Applicant** Peace Reform Church  
**Address:** 638 Huddle Rd

**Approval Date:** 9/14/2005

Napoleon, OH 43545

**Phone:** 419-599-3106

**Owners**

**Name:** Peace Reform Church  
**Address:** 638 Huddle Rd

**Phone:** 419-599-3106

**Contractors**

**Fees and Receipts:**

| Number             | Description                | Amount         |
|--------------------|----------------------------|----------------|
| FEE2005-717        | Plumbing/outside clean out | \$25.00        |
| <b>Total Fees:</b> |                            | <b>\$25.00</b> |

**Description of work to be done:**

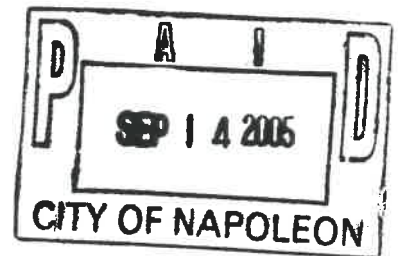

**Applicant signature:**

*James F. Bush* **Date:** *9-14-05*



**CITY OF NAPOLEON GENERAL PERMIT APPLICATION**  
**THIS APPLICATION IS FOR RESIDENTIAL CONSTRUCTION INCLUDING BUILDING, ELECTRICAL, PLUMBING, MECHANICAL, DEMOLITIONS, REMODELING.**

DATE: \_\_\_\_\_ JOB LOCATION: <sup>940</sup> East Mainway

OWNER: Peace Reform Church PHONE: ~~599-3106~~ - 599-3106

OWNER ADDRESS: Huddle Rd 638 CITY: Napoleon ZIP: 43545

CONTRACTOR: None PHONE: \_\_\_\_\_  
 CONTRACTOR LICENSED WITH THE CITY OF NAPOLEON?: YES: \_\_\_\_\_ NO: \_\_\_\_\_

Is any of this job going to be subcontracted out? Yes: \_\_\_\_\_ No: X

If yes to whom: members of the church

DESCRIPTION OF WORK TO BE PERFORMED: footer drain

**PLEASE MARK THE TYPE OF WORK YOU WILL BE PERFORMING**

- |   |  |
|---|--|
| <input type="checkbox"/> A/C ADD ON                 | <input type="checkbox"/> REMODELING              |
| <input type="checkbox"/> BOILER REPLACEMENT         | <input type="checkbox"/> ROOFING                 |
| <input type="checkbox"/> CURBING                    | <input type="checkbox"/> SEWER REPAIRS**         |
| <input type="checkbox"/> DECKS *                    | <input type="checkbox"/> SIDEWALK*               |
| <input type="checkbox"/> DRIVEWAY*                  | <input type="checkbox"/> SIDING                  |
| <input type="checkbox"/> ELECTRICAL SERVICE UPGRADE | <input type="checkbox"/> STORAGE SHED*           |
| <input type="checkbox"/> ELECTRICAL SERVICE NEW     | <input type="checkbox"/> SWIMMING POOL*          |
| <input type="checkbox"/> FENCE*                     | <input type="checkbox"/> FURNACE REPLACEMENT     |
| <input type="checkbox"/> ADDITIONS*                 | <input type="checkbox"/> TEMP ELECTRIC           |
| <input type="checkbox"/> FURNACE NEW                | <input type="checkbox"/> WATER TAP (size _____") |
| <input type="checkbox"/> LAWN METER                 | <input type="checkbox"/> WINDOWS                 |
| <input type="checkbox"/> PLUMBING                   | <input type="checkbox"/> ZONING                  |

**\*PLEASE INCLUDE A PICTURE SHOWING MEASUREMENTS FROM EXISTING STRUCTURES AND PROPERTY LINES. INDICATING THE TYPE OF WORK YOU WISH TO PERFORM.**

**\*\* IF WORK REQUIRES GOING INTO THE STREET A STREET BOND IS REQUIRED!**

**FOR PERMIT COSTS PLEASE FILL OUT REVERSE SIDE.**

## PERMIT COST WORKSHEET

| JOB                                      | BASE FEE  | TOTAL    |
|--|-----------|----------|
| SIDING (only) TOTAL SQ _____ X 1.00 +    | \$5.00 =  | \$ _____ |
| ROOFING (only) TOTAL SQ _____ X 1.00 +   | \$5.00 =  | \$ _____ |
| WINDOWS (only) # OF WINDOWS ___ X 1.00 + | \$5.00 =  | \$ _____ |
| ELECTRICAL # OF CIRCUITS _____ X 3.00 +  | \$15.00 = | \$ _____ |
| ELECTRICAL SERVICE UPGRADE               | \$15.00 = | \$ _____ |
| PLUMBING (INSIDE) repairs only           | \$10.00 = | \$ _____ |
| PLUMBING/SEWER (OUTSIDE)                 | \$25.00 = | \$ _____ |
| WATER HEATER                             | \$5.00    | \$ _____ |
| SHED UNDER 200 SQ FT                     | \$ 5.00   | \$ _____ |
| FURNACE OR A/C (REPLACEMENT)             | \$ 5.00   | \$ _____ |
| DEMOLITION (only)                        | \$30.00   | \$ _____ |
| SIDEWALK REPLACEMENT/ NEW                | \$25.00   | \$ _____ |
| DRIVEWAY                                 | \$25.00   | \$ _____ |

ALL CONSTRUCTION, ALTERATIONS, REMODELING, SHEDS, DECKS & FENCES NOT LISTED ABOVE IS BASED ON COST OF WORK BEING PERFORMED.

COST OF WORK \$ \_\_\_\_\_ (SEE CHART) \$ \_\_\_\_\_

|           |   |           |       |             |   |             |       |
|-----------|---|-----------|-------|-------------|---|-------------|-------|
| 0.00      | - | 250.00    | 0.00  | 11,000.00   | - | 11,999.00   | 25.00 |
| 250.00    | - | 1,000.00  | 10.00 | 12,000.00   | - | 12,999.00   | 26.00 |
| 1,000.00  | - | 1,999.00  | 12.00 | 13,000.00   | - | 13,999.00   | 27.00 |
| 2,000.00  | - | 2,999.00  | 14.00 | 14,000.00   | - | 14,999.00   | 28.00 |
| 3,000.00  | - | 3,999.00  | 16.00 | 15,000.00   | - | 15,999.00   | 29.00 |
| 4,000.00  | - | 4,999.00  | 18.00 | 16,000.00   | - | 16,999.00   | 30.00 |
| 5,000.00  | - | 5,999.00  | 19.00 | 17,000.00   | - | 17,999.00   | 31.00 |
| 6,000.00  | - | 6,999.00  | 20.00 | 18,000.00   | - | 18,999.00   | 32.00 |
| 7,000.00  | - | 7,999.00  | 21.00 | 19,000.00   | - | 19,999.00   | 33.00 |
| 8,000.00  | - | 8,999.00  | 22.00 | 20,000.00   | - | 20,999.00   | 34.00 |
| 9,000.00  | - | 9,999.00  | 23.00 | 21,000.00   | - | 21,999.00   | 35.00 |
| 10,000.00 | - | 10,999.00 | 24.00 | 22,000.00   | - | 22,999.00   | 36.00 |
|           |   |           |       | Over 22,999 |   | Please Call |       |

Date Installed: 9-19-05  
Installed by: Tim Busch  
Inspected by: Rex Moll

### 4" ADS - Perf. Footer drains

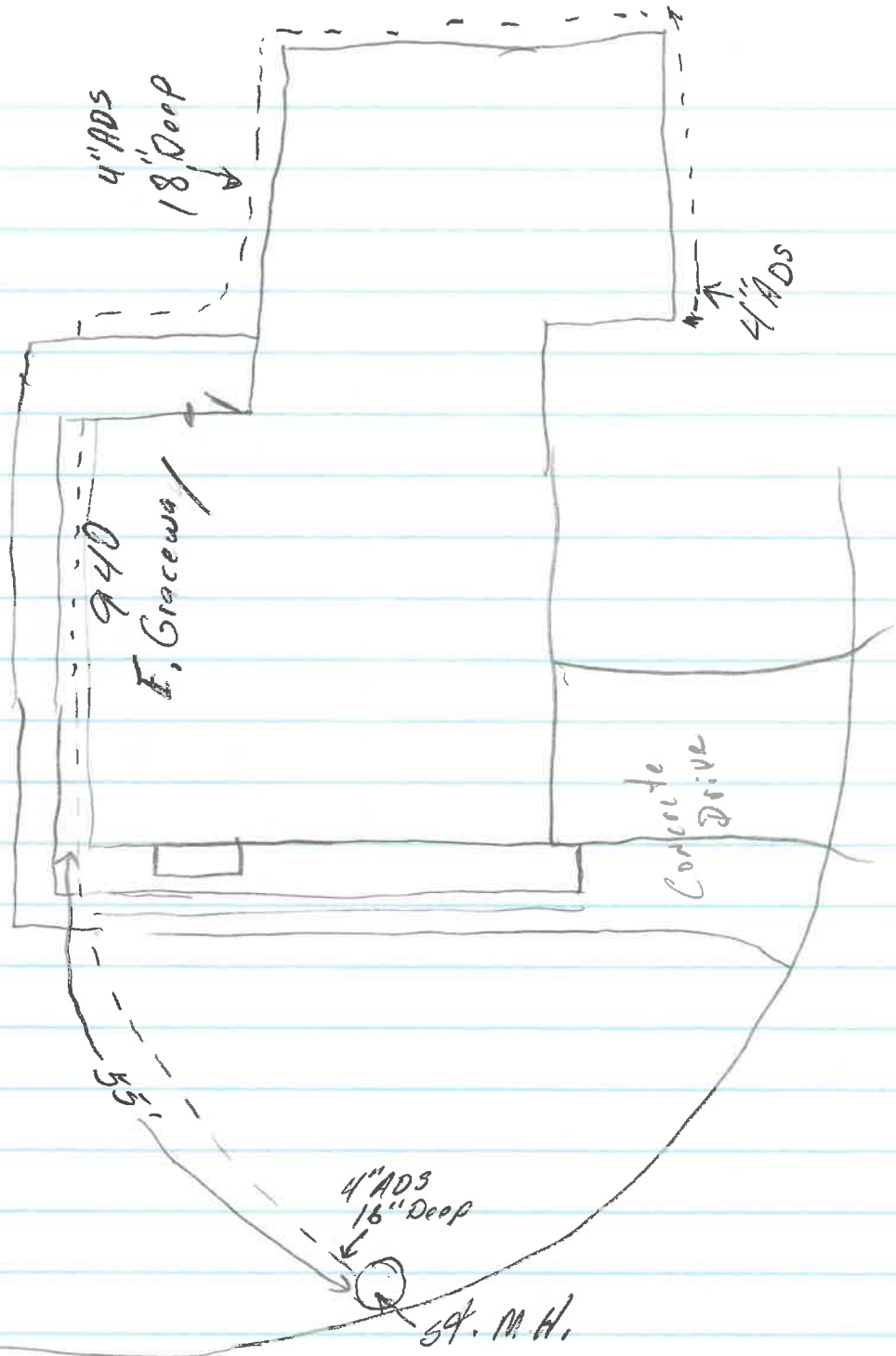



# City of Napoleon

## BUILDING & ZONING DEPARTMENT

255 W Riverview

(419)592-4010

---

### Inspection Record

Inspection #: INSP2005-306

Page: 1

Printed: 9/20/2005

---

Address: 940 Graceway Dr E.  
Napoleon, OH 43545

Reference #: PL2005-53

Applicant: Peace Reform Church

Directions To Parcel:

Inspection Type: Final

Date: 9/20/2005

Inspector: Rex

Status: Approved

Passed?

Required Steps:

Comments:

#### Inspection Checklist:

Building

Plumbing

Smoke Detectors

Mechanical/Heating

Roofing

Electrical

Footer/ Foundation

Sidewalk

Siding/Windows

Sewer

---

#### Corrections:

Correction Code:

Date:

Correction Description:

Status:

Correction Made Date:

---

#### Conditions:

Condition Code:

Description:

Date:

Department:

Status:

---

Other Fields:

